

Component General, Inc.

■ Stripline Base Mounted Resistors

■ MECHANICAL SPECIFICATIONS



Heat Sink :	Copper, Nickel Plated per QQ-N-290.
Substrate :	Beryllium Oxide Ceramic.
Contact :	Beryllium Copper, Gold Plated per MIL-G-45204.
Thickness :	0.004" ± 0.002".
Cover :	Alumina Ceramic.
Tolerance :	± 0.010" unless specified

4 hole base mounted resistors product selection chart					
CGI P/N	Power	Resistance (Ohms)	Standard Tolerance	Frequency Range	VSWR (Max.)
Note: Click a part number from the list below to see a data sheet for that part.					
CBR-250-3	250 W	10 - 1000	5 %	DC - .1 GHz .1 - .5 GHz .5 - 1.0 GHz	1:05:1 1:10:1 1:20:1
CBR-700	700 W	10 - 1000	5 %	DC - .5 GHz .5 - .65 GHz .65 - .89 GHz	1:15:1 1:25:1 1:50:1
CBR-800	800 W	10 - 1000	5 %	DC - .2 GHz .2 - .5 GHz	1:25:1 1:50:1

Component General, Inc.

P/N: CBR-250-3

Stripline Base Mounted Resistors

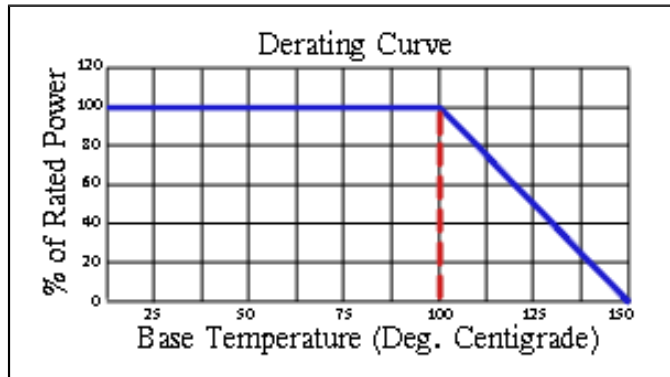
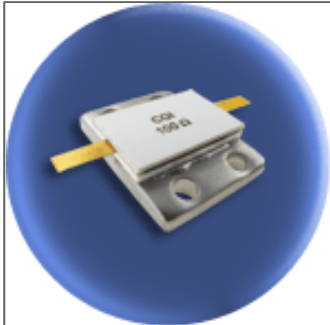

Mechanical Specifications

Covers:

Alumina Ceramic.

Substrate:

Beryllium Oxide Ceramic.

Contact:

Beryllium Copper, Gold Plated per MIL-G-45204.
Length: 0.300" Min., Width: 0.120",
Thickness 0.004" \pm 0.002".

Heat Sink:

Copper, Nickel Plated per QQ-N-290.

Tolerance:

\pm 0.010" unless specified.

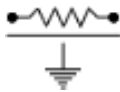

Note: The use of thermal mounting compound is recommended.

Electrical Specifications

Resistance Value:

10 - 1000 Ω or as required. Other values available upon request.

Standard Resistance Tolerance:

\pm 5% Other tolerances available upon request.

Frequency Range:

DC - .1 GHz

.1 - .5 GHz

.5 - 1.0 GHz

Part Dimensions

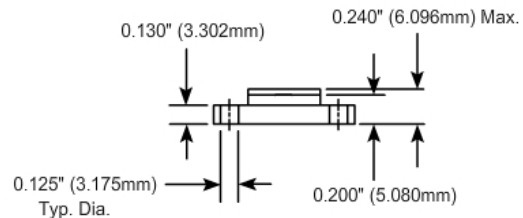
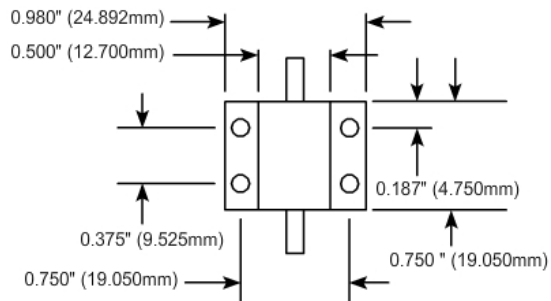

Component General, Inc.

P/N: CBR-700

Stripline Base Mounted Resistors

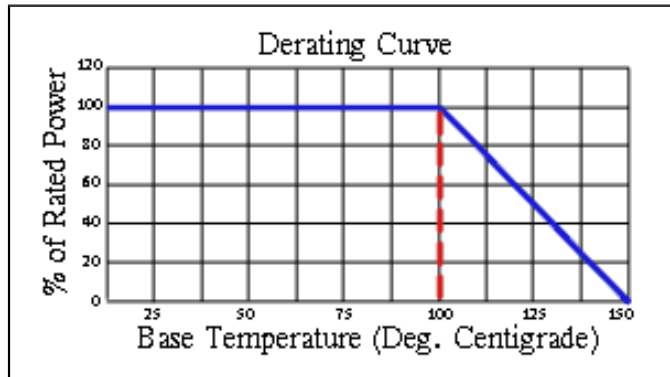

Mechanical Specifications

Covers:

Alumina Ceramic.

Substrate:

Beryllium Oxide Ceramic.

Contact:

Beryllium Copper, Gold Plated per MIL-G-45204.
Length: 0.125" Min., Width: 0.250",
Thickness 0.004" \pm 0.002".

Heat Sink:

Copper, Nickel Plated per QQ-N-290.

Tolerance:

\pm 0.010" unless specified.

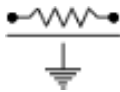

Note: The use of thermal mounting compound is recommended.

Electrical Specifications

Resistance Value:

10 - 1000 Ω or as required. Other values available upon request.

Standard Resistance Tolerance:

\pm 5% Other tolerances available upon request.

Frequency Range:

DC - .5 GHz
.5 - .65 GHz
.65 - .89 GHz

Part Dimensions

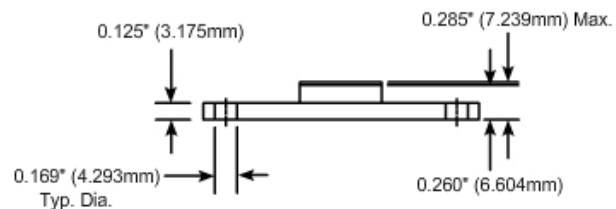
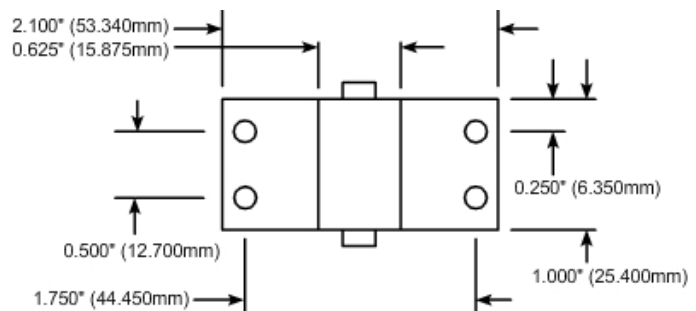

Component General, Inc.

P/N: CBR-800

Stripline Base Mounted Resistors

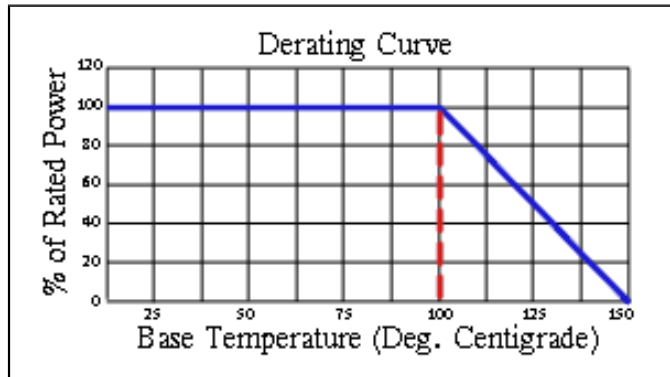
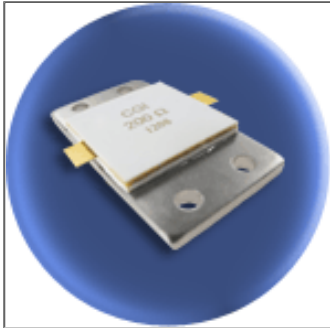

Mechanical Specifications

Covers:

Alumina Ceramic.

Substrate:

Beryllium Oxide Ceramic.

Contact:

Beryllium Copper, Gold Plated per MIL-G-45204.
Length: 0.125" Min., Width: 0.250",
Thickness 0.004" \pm 0.002".

Heat Sink:

Copper, Nickel Plated per QQ-N-290.

Tolerance:

\pm 0.010" unless specified.

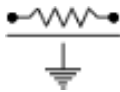

Note: The use of thermal mounting compound is recommended.

Electrical Specifications

Resistance Value:

10 - 1000 Ω or as required. Other values available upon request.

Frequency Range:

DC - .2 GHz
.2 - .5 GHz

Standard Resistance Tolerance:

\pm 5% Other tolerances available upon request.

Part Dimensions

